

Wire Wound Inductors

Features

- High reliable wire wound structure in encapsulated case.
- Ideal for automatic surface mounting.
- High resistance to heat and humidity
- Resistance to mechanical shocks and pressure.
- Accurate dimension for automatically surface mount.
- Large current type, best for Power Supply Line.

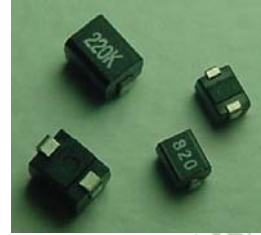

Applications

- Digital cameras, Computer peripherals, Portable telephone, HDD

Part Number Systems

WIC - 4532 - 1R0 - K - LF

(1) (2) (3) (4) (5)

(1)	Product series	(2)	Size
(3)	Inductance Value: 1R0 = 1.0uH	(4)	Inductance Tolerance: K = ± 10%, M = ± 20%
(5)	ROHs Compliant		

Shape And Dimensions

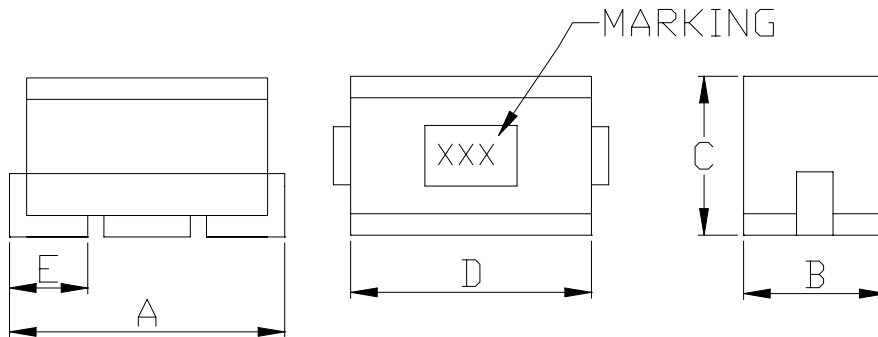

Unit: mm

Type	A	B	C	D	E Ref.
4532	4.5 ± 0.3	3.2 ± 0.2	3.2 ± 0.2	4.2 ± 0.2	0.9

Wire Wound Inductors

WIC-4532(1812)-Series			ELECTRICAL CHARACTERISTICS			
Part Number	Inductance (uH)	Tolerance	Q Min	SRF (MHz)	Rdc (Ω)	Idc (mA)
				Min	Max	Max
WIC-4532-1R0K-LF	1.00 @ 7.96 MHz	K	10 @ 7.96 MHz	180	0.11	1050
WIC-4532-1R2K-LF	1.20 @ 7.96 MHz	K	10 @ 7.96 MHz	160	0.12	1000
WIC-4532-1R5K-LF	1.50 @ 7.96 MHz	K	10 @ 7.96 MHz	130	0.15	950
WIC-4532-1R8K-LF	1.80 @ 7.96 MHz	K	10 @ 7.96 MHz	100	0.16	900
WIC-4532-2R2K-LF	2.20 @ 7.96 MHz	K	10 @ 7.96 MHz	80	0.18	850
WIC-4532-2R7K-LF	2.70 @ 7.96 MHz	K	10 @ 7.96 MHz	60	0.20	800
WIC-4532-3R3K-LF	3.30 @ 7.96 MHz	K	10 @ 7.96 MHz	45	0.22	750
WIC-4532-3R9K-LF	3.90 @ 7.96 MHz	K	10 @ 7.96 MHz	40	0.24	700
WIC-4532-4R7K-LF	4.70 @ 7.96 MHz	K	10 @ 7.96 MHz	35	0.27	650
WIC-4532-5R6K-LF	5.60 @ 7.96 MHz	K	10 @ 7.96 MHz	30	0.30	650
WIC-4532-6R8K-LF	6.80 @ 7.96 MHz	K	10 @ 7.96 MHz	28	0.35	600
WIC-4532-8R2K-LF	8.20 @ 7.96 MHz	K	10 @ 7.96 MHz	25	0.40	600
WIC-4532-100K-LF	10 @ 2.52 MHz	K	10 @ 2.52 MHz	22	0.50	550
WIC-4532-120K-LF	12 @ 2.52 MHz	K	10 @ 2.52 MHz	21	0.60	500
WIC-4532-150K-LF	15 @ 2.52 MHz	K	10 @ 2.52 MHz	20	0.70	450
WIC-4532-180K-LF	18 @ 2.52 MHz	K	10 @ 2.52 MHz	19	0.80	400
WIC-4532-220K-LF	22 @ 2.52 MHz	K	10 @ 2.52 MHz	18	0.90	370
WIC-4532-270K-LF	27 @ 2.52 MHz	K	10 @ 2.52 MHz	16	1.2	330
WIC-4532-330K-LF	33 @ 2.52 MHz	K	10 @ 2.52 MHz	14	1.4	300
WIC-4532-390K-LF	39 @ 2.52 MHz	K	10 @ 2.52 MHz	12	1.6	280
WIC-4532-470K-LF	47 @ 2.52 MHz	K	10 @ 2.52 MHz	11.5	1.9	260
WIC-4532-560K-LF	56 @ 2.52 MHz	K	10 @ 2.52 MHz	11	2.2	240
WIC-4532-680K-LF	68 @ 2.52 MHz	K	10 @ 2.52 MHz	10	2.6	220
WIC-4532-820K-LF	82 @ 2.52 MHz	K	10 @ 2.52 MHz	9	3.5	200
WIC-4532-101K-LF	100 @ 0.796 MHz	K	20 @ 0.796 MHz	8	4	180
WIC-4532-121K-LF	120 @ 0.796 MHz	K	20 @ 0.796 MHz	7.5	4.5	160
WIC-4532-151K-LF	150 @ 0.796 MHz	K	20 @ 0.796 MHz	7	6.5	140
WIC-4532-181K-LF	180 @ 0.796 MHz	K	20 @ 0.796 MHz	6.5	7.5	120
WIC-4532-221K-LF	220 @ 0.796 MHz	K	20 @ 0.796 MHz	5.5	9	120
WIC-4532-271K-LF	270 @ 0.796 MHz	K	20 @ 0.796 MHz	5	11	100
WIC-4532-331K-LF	330 @ 0.796 MHz	K	20 @ 0.796 MHz	4	13	90
WIC-4532-391K-LF	390 @ 0.796 MHz	K	30 @ 0.796 MHz	3	13.5	85

* All specifications are subjected to change without prior notice.

Wire Wound Inductors

WIC-4532(1812)-Series			ELECTRICAL CHARACTERISTICS			
Part Number	Inductance (uH)	Tolerance	Q Min	SRF (MHz)	Rdc (Ω)	Idc (mA)
				Min	Max	Max
WIC-4532-471K-LF	470 @ 0.796 MHz	K	30 @ 0.796 MHz	3	15	75
WIC-4532-561K-LF	560 @ 0.796 MHz	K	30 @ 0.796 MHz	3	17	70
WIC-4532-681K-LF	680 @ 0.796 MHz	K	30 @ 0.796 MHz	2.5	22.8	65

* All specifications are subjected to change without prior notice.