

Wire Wound Inductors

Features

- High reliable wire wound structure in encapsulated case.
- Ideal for automatic surface mounting.
- High resistance to heat and humidity
- Resistance to mechanical shocks and pressure.
- Accurate dimension for automatically surface mount.
- Large current type, best for Power Supply Line.

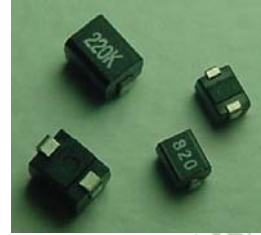

Applications

- Digital cameras, Computer peripherals, Portable telephone, HDD

Part Number Systems

WIC - 3225 - 1R0 - K - LF

(1) (2) (3) (4) (5)

(1)	Product series	(2)	Size
(3)	Inductance Value: 1R0 = 1.0uH	(4)	Inductance Tolerance: K = ± 10%, M = ± 20%
(5)	ROHs Compliant		

Shape And Dimensions

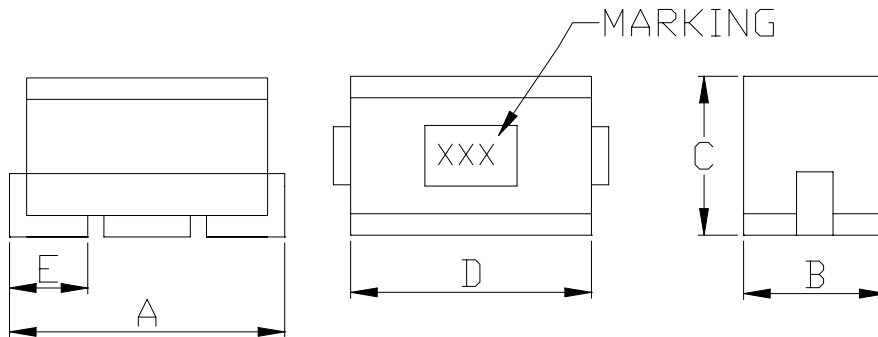

Unit: mm

Type	A	B	C	D	E Ref.
3225	3.2 ± 0.4	2.5 ± 0.2	2.2 ± 0.2	2.9 ± 0.2	0.6

Wire Wound Inductors

WIC-3225(1210)-Series			ELECTRICAL CHARACTERISTICS			
Part Number	Inductance (uH)	Tolerance	Q Min	SRF (MHz) Min	Rdc (Ω) Max	Idc (mA) Max
WIC-3225-1R0M-LF	1.00 @ 7.96 MHz	M	10 @ 7.96 MHz	100	0.156	770
WIC-3225-1R5M-LF	1.50 @ 7.96 MHz	M	10 @ 7.96 MHz	80	0.195	580
WIC-3225-2R2M-LF	2.20 @ 7.96 MHz	M	10 @ 7.96 MHz	65	0.260	480
WIC-3225-3R3M-LF	3.30 @ 7.96 MHz	M	10 @ 7.96 MHz	55	0.325	400
WIC-3225-4R7M-LF	4.70 @ 7.96 MHz	M	10 @ 7.96 MHz	45	0.520	320
WIC-3225-6R8M-LF	6.80 @ 7.96 MHz	M	10 @ 7.96 MHz	35	0.650	280
WIC-3225-100K-LF	10 @ 2.52 MHz	K	15 @ 2.52 MHz	28	1.105	220
WIC-3225-150K-LF	15 @ 2.52 MHz	K	15 @ 2.52 MHz	25	1.690	180
WIC-3225-220K-LF	22 @ 2.52 MHz	K	15 @ 2.52 MHz	20	2.600	145
WIC-3225-330K-LF	33 @ 2.52 MHz	K	15 @ 2.52 MHz	15	3.640	115
WIC-3225-470K-LF	47 @ 2.52 MHz	K	20 @ 2.52 MHz	13	5.460	105
WIC-3225-680K-LF	68 @ 2.52 MHz	K	20 @ 2.52 MHz	10	8.450	85
WIC-3225-101K-LF	100 @ 0.796 MHz	K	20 @ 0.796 MHz	8	10.140	75

* All specifications are subjected to change without prior notice.