

REVISIONS							
SYM	DISCIPTION	DATE	APPROVED	SYM	DISCIPTION	DATE	APPROVED
△				△			
△				△			

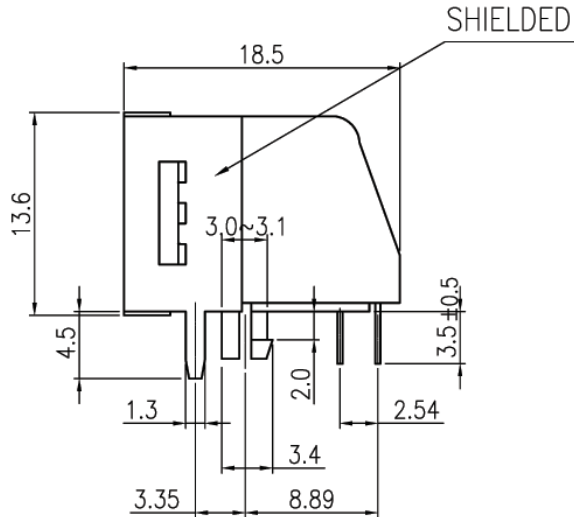

MATERIAL:
 HOUSING: STANDARD MATERIAL GLASS FILLED POLYESTER UL-94V-0 STANDARD COLOUR(BLACK)
 CONTACT: 0.35mm THICKNESS PHOS-BRONZ.
 GOLD PLATING OVER NICKEL IN CONTACT AREA.
 TIN PLATING OVER NICKEL IN CONTACT AREA.
 GOLD PLATING: SELECTIVE GOLD PLATING

ORDER INFORMATION:
 MJK659-Pa881GxtScF
 MJK: MODULAR JACK
 659: SERIES NO.
 Pa: TERMINAL TYPE, PCB TYPE STRAIGHT
 88: NO. OF CONTACT, 8P8C
 1: COLOR OF PLASTIC, BLACK
 Gxt: CONTACT PLATING OPTION
 -Gft: GOLD FLUSH ON CONTACT, TIN PLATING ON SOLDER TAIL
 -G15t: 15u" GOLD ON CONTACT, TIN PLATING ON SOLDER TAIL
 -G30t: 30u" GOLD ON CONTACT, TIN PLATING ON SOLDER TAIL
 -G50t: 50u" GOLD ON CONTACT, TIN PLATING ON SOLDER TAIL
 Sc: HALF (FRONT) SHIELDING
 F: FLANGED

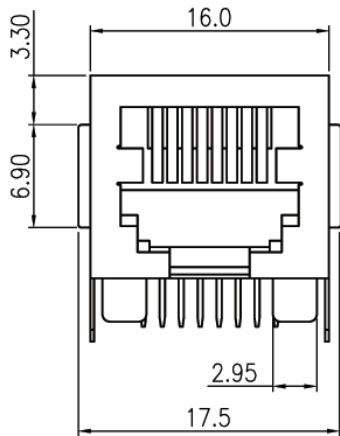
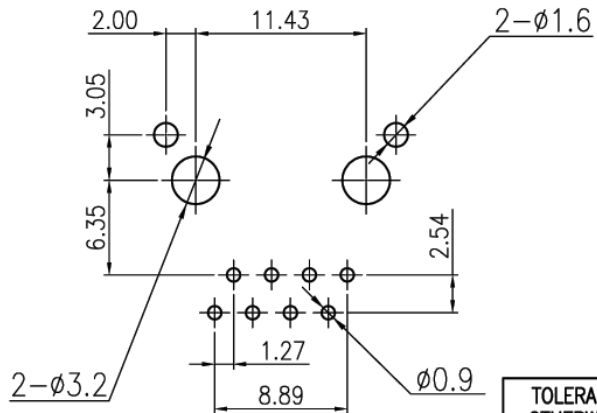
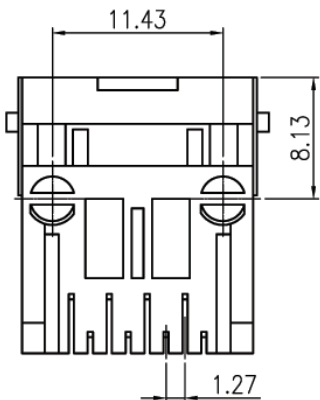

PC BOARD LAYOUT

TOLERANCES UNLESS OTHERWISE SPECIFIED ±0.30			SIGNATURES		DATE	MODEL			
			DRAWN	VIVI	12/MAY/03'	TITLE	MODULAR JACK		
SYMBOL △			UNIT	SCALE	CHECKED	ZOLA	12/MAY/03'	NO.	MJK659-Pa881G_tScF
			mm	3/1	APPROVALS				

Machrone