

8 7 6 5 4 3 2 1

V1-1

REVISIONS							
SYM	DESCRIPTION	DATE	APPROVED	SYM	DESCRIPTION	DATE	APPROVED
△				△			
△				△			
**CUSTOMER DRAWING FOR REFERENCE ONLY, SAMPLES APPROVAL ARE REQUIRED!!							123

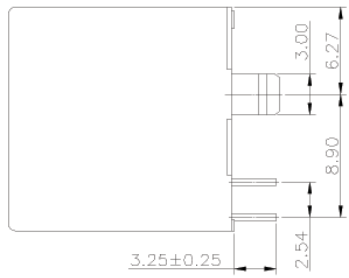
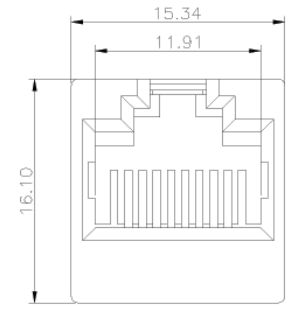

MATERIAL:  
 HOUSING: PBT POLYESTER UL-94V-0  
 MIXED GLASS FIBER.  
 STANDARD COLOR-BLACK  
 CONTACTS: 0.35mm THICK PHOS-BRONZE  
 PLATED WITH HARD GOLD AND  
 TIN/LEAD IN SOLDER AREA.

CAVITY CONFIRMS TO FCC RULES AND REGULATIONS  
 PART 68,SUBPART F.

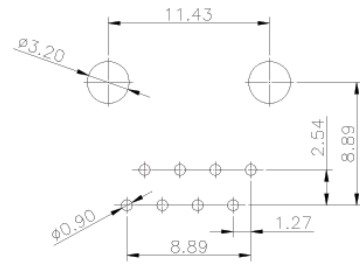
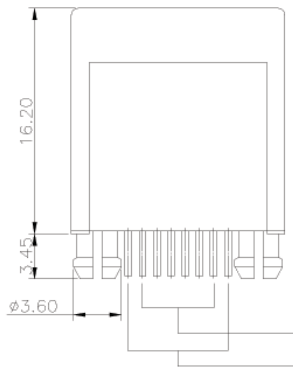

8P8C  
PC BOARD LAYOUT

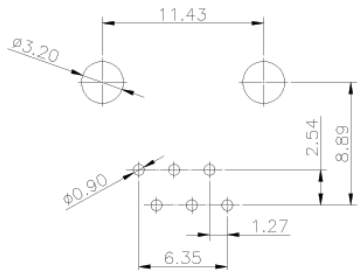

6P6C  
PC BOARD LAYOUT

ORDER INFORMATION:  
 MJK646-PXX1Gft  
 MJK: MODULAR JACK  
 1882: SERIES NO.  
 P: TERMINAL TYPE, PCB TYPE, STRAIGHT  
 XX: NO. OF CONTACT  
 88, 8P8C  
 66, 6P6C  
 1: COLOR OF PLASTIC, BLACK  
 Gft: GOLD FLASH ON CONTACT,  
 TIN PLATING ON SOLDER

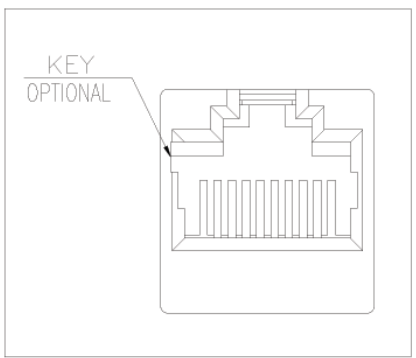

TOLERANCES UNLESS OTHERWISE SPECIFIED ±0.25			SIGNATURES		DATE	MODEL
			DRAWN Frederick		14/APR/05	TITLE
			CHECKED Sam		14/APR/05	NO. MODULAR JACK
			APPROVALS			MJK646-PXX1Gft

**Machrone**

8 7 6 5 4 3 2 1